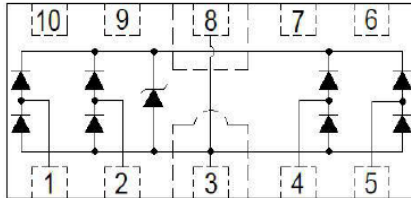

DFN10L

Features

- 45Watts peak pulse power($t_p=8/20\mu s$)
- Protect up to 4-lines
- Low clamping voltage
- Low leakage current
- Glass passivated junction
- Unidirectional configurations
- IEC 61000-4-2 $\pm 25KV$ contact $\pm 25KV$ air
- Halogen free and RoHS compliant

Mechanical Data

- CASE: DFN10L Molded Plastic
- Molding compound flammability rating: UL 94V-0
- Mounting Position:Any

Making Code & Ordering information

<div style="border: 1px solid black; padding: 5px; display: inline-block;"> 5R2P </div>	<table border="1"> <thead> <tr> <th>Ordercode</th> <th>Package</th> <th>Base qty</th> <th>Deliverymode</th> </tr> </thead> <tbody> <tr> <td>PDF10U05A4</td> <td>DFN10L</td> <td>3000</td> <td>Tape and reel</td> </tr> </tbody> </table>	Ordercode	Package	Base qty	Deliverymode	PDF10U05A4	DFN10L	3000	Tape and reel
Ordercode	Package	Base qty	Deliverymode						
PDF10U05A4	DFN10L	3000	Tape and reel						

Maximum Ratings & Thermal Characteristics

(Ratings at 25°C ambient temperature unless otherwise specified.)

Rating	Symbol	Value	Units
Peak Pulse Power ($t_p=8/20\mu s$)	P_{PP}	45	Watts
Peak Pulse Current ($t_p=8/20\mu s$) (note1)	I_{PP}	3.5	A
ESD per IEC 61000-4-2 (Air) ESD per IEC 61000-4-2 (Contact)	V_{ESD}	25 25	kV
Lead Soldering Temperature	T_L	260(10seconds)	°C
Junction Temperature	T_J	-55 to + 125	°C
Storage Temperature	T_{stg}	-55 to + 125	°C

Electrical Characteristics

(Ratings at 25°C ambient temperature unless otherwise specified).

Parameter	Symbol	Conditions	Min	Typical	Max	Units
Reverse Stand-Off Voltage	V_{RWM}				5.0	V
Reverse Breakdown Voltage	V_{BR}	$I_T=1mA$	5.5	7.5		V
Reverse Leakage Current	I_R	$V_{RWM}=5V, T=25^\circ C$			0.5	μA
Peak Pulse Current	I_{PP}	$t_p=8/20\mu s$			3.5	A
Clamping Voltage	V_C	$I_{PP}=3.5A, t_p=8/20\mu s$		12	15	V
Junction Capacitance	C_j	$V_R=0V, f=1MHz$ I/O to I/O		0.35	0.4	pF
		$V_R=0V, f=1MHz$ I/O to GND		0.7	0.8	

Ratings and Characteristic Curves

(Ratings at 25°C ambient temperature unless otherwise specified).

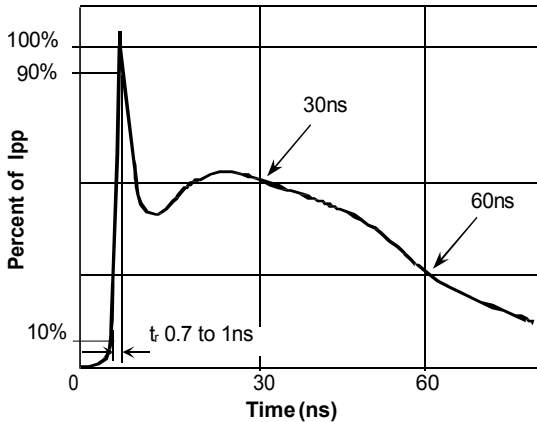

Fig.1 IEC61000-4-2 Waveform

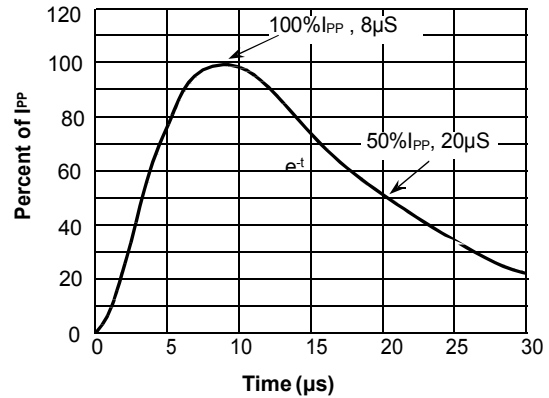

Fig.2 Pulse Waveform-8/20µs

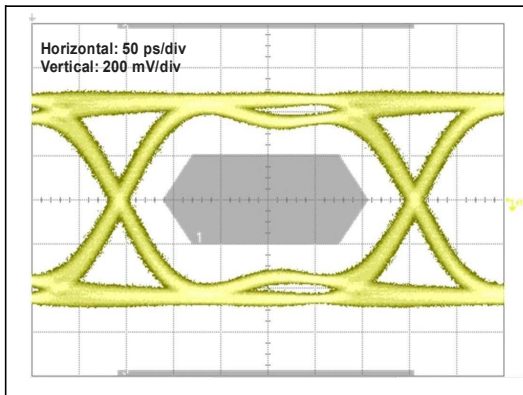

Fig.3 Eye Diagram - HDMI mask at 3.4Gbps per channel

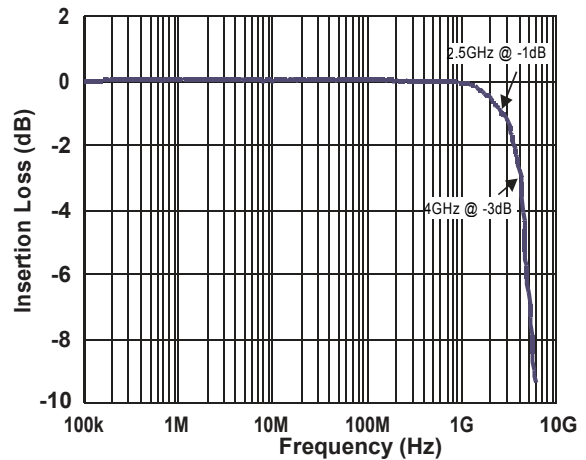
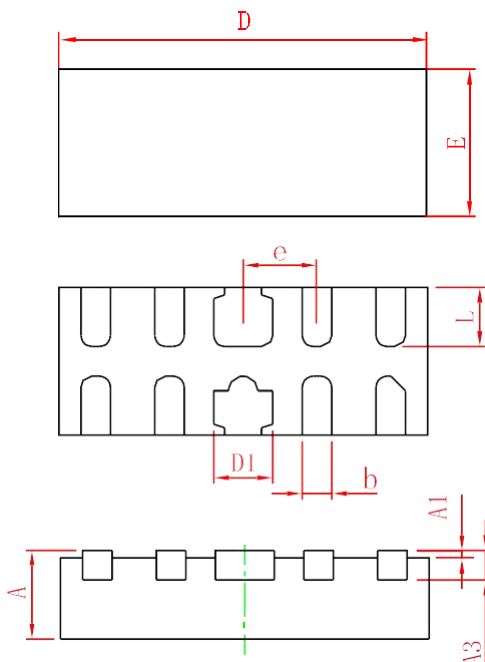

Fig.4 Insertion Loss S21 - I/O to GND

Package Outline Dimensions: DFN10L(2.5mm*1.0mm)



Symbol	Dimensions in millimeters		
	Min	Nom	Max
A	0.45	0.50	0.55
A1	-	0.02	0.05
A3	0.10	0.15	0.20
D	2.45	2.50	2.55
E	0.95	1.00	1.05
D1	0.35	0.40	0.45
b	0.15	0.20	0.25
e	0.50BSC		
L	0.35	0.40	0.45